

Optional function parts

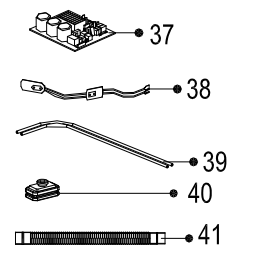

For some models

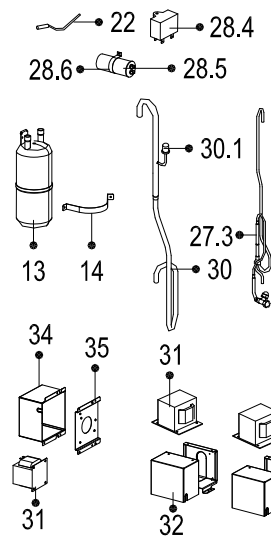

## Exploded View

Product code :  
Customer model :

22022516001302  
KOE30U-55HFN32

EX_ID	Spare Parts Code	Part Name(EN)	Qty.	Min Shipments	Part Status	Remarks	Long Term Material(Y or N)	High Rate of Replacement(Y or N)	Option Parts
1	11201007003448	Room temperature sensor	1		In use				
2	15822000008305	Condenser Assembly	1		In use				
2	15822000008314	Condenser Assembly	1		In use				
3	15822000008305	Condenser Assembly	1		In use				
3	15822000008314	Condenser Assembly	1		In use				
4	11201007003439	Pipe Temperature Sensor	1		In use				
5	12222200001115	Big handle	1		In use				
6	12222200004215	Rear right clapboard assembly	1		In use				
6.1	12100702000038	handle	1		In use				
8	12122000014023	Water collector	1		In use				
9	12222000006287	Front right clapboard assembly	1		In use				
10	12222200002361	Valve plate	1		In use				
11	12222000006290	Chassis assembly	1		In use				
12	12222000005733	Partition board assembly	1		In use				
13	15500508000009	Liquid-storage tank	1		In use				
15	12222200002363	Left side plate assembly of cabinet	1		In use				
16	12122000020244	Air outlet grille	2		In use				
17	12222000006291	Front panel	1		In use				
18	12100105000022	Axial flow fan	2	0	In use		N	Y	
19	11002015002241	Brushless DC Motor	2		In use				
20	12222000006288	Supporter subassembly of fan motor	1		In use				
21	15500406000003	Copper nut	1	0	In use		N	N	
21	15500406000010	Copper nut	1	0	In use		N	N	
22	11201007003124	Discharge Temperature Sensor	1		In use				
23	12222200002359	Top cover assembly	1		In use				
24	11103020002859	DC Inverter Rotary Compressor	1		In use				
25	15123000008507	Discharge pipe assembly	1		In use				
25.1	17400516000020	Pressure switch	1		In use				

26	1542300002958	4-way valve assembly	1		In use			
26.2	15500204000061	Gas valve	1		In use			
26.3	15500216000681	4-way valve	1		In use			
27	15422000015574	Liquid valve assembly	1		In use			
27.1	15500208000286	Liquid valve	1		In use			
27.3	15500213000245	Electronic expansion valve	1		In use			
28	17222000029115	Electronic control box subassembly	1		In use			
28.1	12222000006289	Installation plate of electric parts subassembly	1		In use			
28.2	17122000045915	Outdoor main control board subassembly	1		In use			
28.9	11201007003427	Discharge Temperature Sensor	1		In use			
28.10	12122000014021	Electronic installing box	1		In use			
28.11	17122000021908	Inverter control board subassembly	1		In use			
28.12	17122000039408	Filter board subassembly	1		In use			
28.13	17400306000032	Reactor	1		In use			
28.14	17401203000936	Compressor wire subassembly	1		In use			
28.16	12122000014182	Electronic installing box	1		In use			
28.17	12122000014022	Electronic installing box	1		In use			
28.20	11201418000002	Rectifier bridge	1	0	In use	N	Y	
29	17222000025408	Terminal board subassembly	1		In use			
29.1	17400401000098	Terminal	1		In use			
29.1	17400401000016	Terminal	1		In use			
29.2	12222000012265	Terminal instalation subassembly	1		In use			
30	15123000008516	Suction pipe assembly	1		In use			
30.1	17400516000008	Pressure switch	1	0	In use	N	Y	
31	17400306000183	Reactor	3		In use			
32	12222000006285	Inductor Cover Assembly	2		In use			
33	12222000006292	Installation base of inductance	2		In use			
34	12222000006284	Inductor Box subassembly	1		In use			
35	12222000006286	Installation base of inductance	1		In use			
46	11201007003124	Discharge Temperature Sensor	1		In use			