

5.5 for some models

46 for some models

36 for some models

19

20 or 5.4

21

22

23

24

25

26

for some models

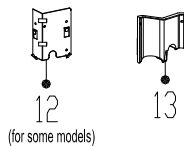
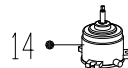
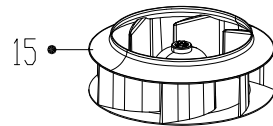
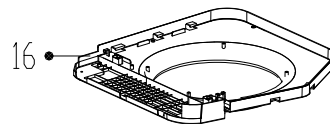
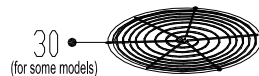
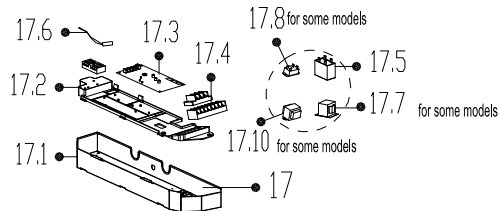
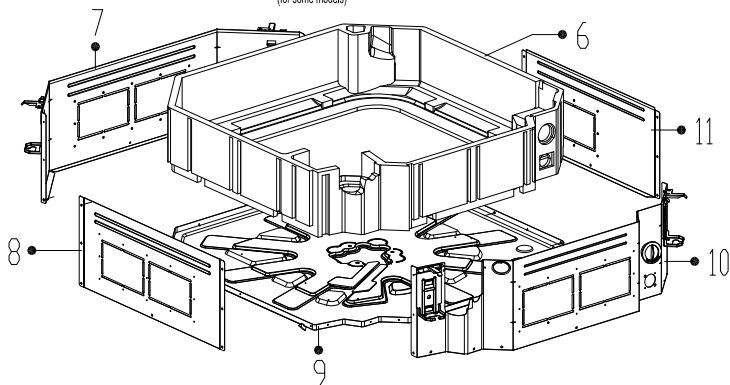
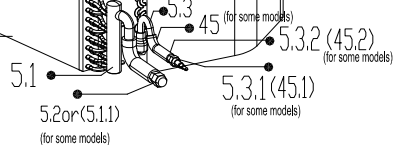
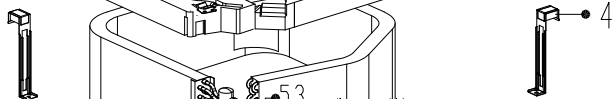
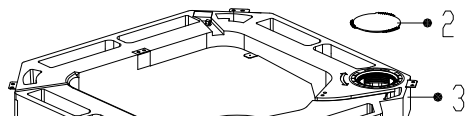
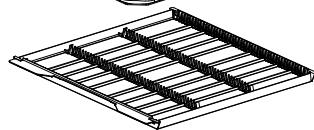
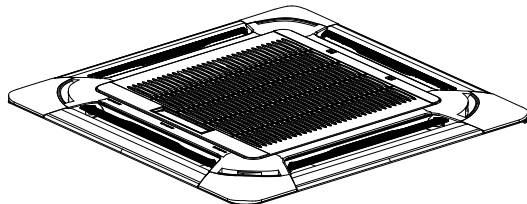
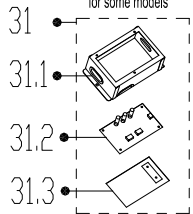

Exploded View

Product code :
Customer model :

22022511002576
KCD-48HRF32

| EX_ID | Spare Parts Code | Part Name(EN) | Qty. | Min Shipments | Part Status | Remarks | Long Term Material(Y or N) | High Rate of Replacement(Y or N) | Option Parts |
|-------|------------------|-------------------------------------|------|---------------|-------------|---------|----------------------------|----------------------------------|--------------|
| 2 | 12122500000025 | Cover subassembly | 1 | | In use | | | | |
| 3 | 128225000000310 | Water collector subassembly | 1 | | In use | | | | |
| 4 | 122225000000090 | Evaporator fixing hanger | 2 | | In use | | | | |
| 5 | 15822500001747 | Evaporator Assembly | 1 | | In use | | | | |
| 5.1 | 15122500002909 | Evaporator outlet pipe subassembly | 1 | | In use | | | | |
| 5.3 | 15122500002908 | Evaporator inlet pipe subassembly | 1 | | In use | | | | |
| 5.4 | 11201007000047 | Pipe temperature sensor | 1 | 0 | In use | | N | Y | |
| 5.5 | 15500209000002 | Detection valve | 1 | | In use | | | | |
| 6 | 128225000000009 | Base foam subassembly | 1 | | In use | | | | |
| 7 | 12222500000133 | coaming subassembly | 1 | | In use | | | | |
| 8 | 12222500000240 | coaming | 1 | | In use | | | | |
| 9 | 12222500000122 | Chassis | 1 | | In use | | | | |
| 10 | 12222500000157 | coaming subassembly | 1 | | In use | | | | |
| 11 | 12222500000233 | coaming | 1 | | In use | | | | |
| 12 | 12222500000105 | Evaporator fixing board subassembly | 1 | | In use | | | | |
| 13 | 121225000000331 | Pipe fixing board subassembly | 1 | | In use | | | | |
| 14 | 11002015000281 | Brushless DC Motor | 1 | | In use | | | | |
| 15 | 12100103000096 | centrifuge fan | 1 | | In use | | | | |
| 16 | 12122500000422 | Ventilation ring | 1 | | In use | | | | |
| 17 | 17222500002040 | Electronic control box subassembly | 1 | | In use | | | | |
| 17.1 | 12222500000119 | Electronic control box | 1 | | In use | | | | |
| 17.2 | 12122500000029 | Insulation plate | 1 | | In use | | | | |
| 17.3 | 17122500002391 | Main control board subassembly | 1 | | In use | | | | |
| 17.4 | 17400401000119 | Terminal | 1 | | In use | | | | |
| 17.6 | 11201007000283 | Room temperature sensor | 1 | | In use | | | | |
| 17.7 | 17400306000403 | NA | 1 | | In use | | | | |

| | | | | | | | | |
|----|----------------|---------------------------------|---|---|--------|--|---|---|
| 18 | 12222500000162 | Electronic control box | 1 | | In use | | | |
| 19 | 17317000A42320 | Remote controller | 1 | | In use | | | |
| 21 | 11201005000006 | Water level sensor | 1 | 0 | In use | | N | Y |
| 22 | 12122500001147 | water pump installation support | 1 | | In use | | | |
| 23 | 17400802000012 | Water pump subassembly | 1 | | In use | | | |
| 24 | 12622500000006 | Drain pump rubber washer | 3 | | In use | | | |
| 25 | 12622500000013 | Drain pipe | 1 | | In use | | | |
| 26 | 12100509000068 | Water pipe | 1 | 0 | In use | | N | N |
| 36 | 12117000002114 | Bracket of remote Controller | 1 | | In use | | | |
| 41 | 12022500000002 | Accessory kit | 1 | | In use | | | |
| 46 | 15500406000003 | Copper nut | 1 | 0 | In use | | N | N |
| 46 | 15500406000010 | Copper nut | 1 | 0 | In use | | N | N |